

WHAT DO I NEED TO KNOW ABOUT SNOW IN NEEPAWA...



SNOW CLEARING PROTOCOL (5:00am start)

1st Priority - key transportation and emergency routes

- Mountain, Hamilton, Mill, Brown & Hospital.

2nd Priority – all other streets and roads, followed by back lanes, etc.

- Plowed in order starting from Mountain Avenue going east and Mountain Avenue going west.

NO PARKING IN SNOW ZONES

Parking on the following streets is prohibited from 1:00 a.m. to 6:00 a.m. from November 1 to April 30:

- Mountain Avenue between Main Street and Commerce Street;
- Hamilton Street between Brown Avenue and Second Avenue;
- Hospital Street;
- First Avenue between Main Street and Brydon Street;
- Brown Avenue between Main Street and Davidson Street;
- Mill Street between First Avenue and Mountain Avenue;
- Ellen Street between First Avenue and Brown Avenue.
- Davidson St between Mountain Av and Brown Avenue



Do not park in the above zones. Should your vehicle impede snow clearing services or pose a hazard, you may be subject to having your vehicle towed at your expense and liability.

SNOW REMOVAL

Snow or ice that falls on your property belongs to you and must be contained on your property.

- ❄ Do not deposit or push snow or ice onto any public street, boulevard or sidewalk. If you do not have space to pile your snow, it is your responsibility to haul it away at your expense.
- ❄ Property owners in the business district fronting Hamilton and Mountain may clear their snow into the curb line of the street. Do not create piles or deposit in a manner that is hazardous or impedes vehicular or pedestrian traffic.
- ❄ Commercial businesses fronting any street (occupied or vacant) must clear and maintain their sidewalks by 10:00 a.m., with further clearing and salt/sand applied (if and when needed).

SNOW GATES – Why are the snow gates not being used?

- The use of the gates for a large volume of wet heavy snow can impede snow clearing operations and subjects the equipment to breakage.



If a ridge was left in front of your driveway, please take a minute to review the following snow clearing tips to reduce the amount of snow that will be left when the plow clears your street.



Tips to assist in reducing the extra pile of snow at the end of your driveway! Our plow operators do use snow gates, however, with large accumulations of snow sometimes the gates cannot hold back all the snow, which then ‘overflows’ over the top of the gate and blocks your driveway.

Here is a suggestion to help reduce this:

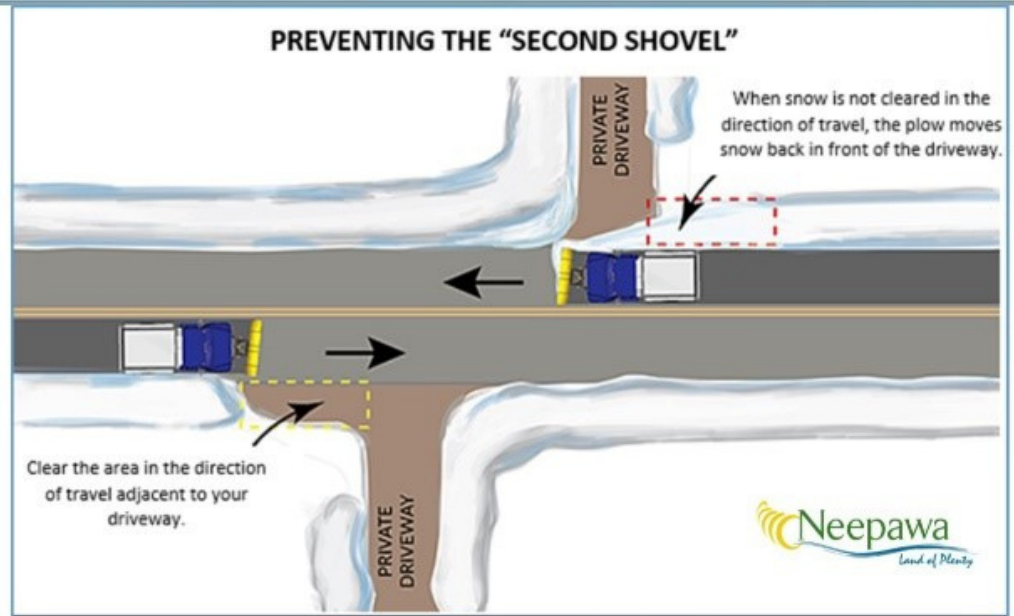

IMPORTANT REMINDERS:

DO NOT PUT SNOW ONTO STREET

All snow from your driveway must remain in your yard, in accordance with By-Law#3134.

DO NOT PARK ON EITHER SIDE OF DRIVEWAY

This makes it difficult to use the snow gates.

DO NOT PARK ON SNOW ROUTES

These routes are for emergency purposes and must be kept clear for the snow plows to pass.

You may be towed.

GARBAGE & RECYCLING COLLECTION DISRUPTIONS

Due to the closure of the highways last Friday, garbage and recycling could not be collected and delivered to the waste site. Services have now resumed and routes will be completed.

If snow removal for your particular street is imminent, please refrain from putting your carts out until the street has been cleared, or take a minute to shovel a spot large enough from your curb to the street for the carts to be placed on clear ground.

If you have any questions, please do not hesitate to contact the Town office by calling 204-476-7600.

